



Decide with Confidence
DUNS NO. : 86-917-7745



DS-LOK

INSTRUMENTATION VALVES AND FITTINGS

By:

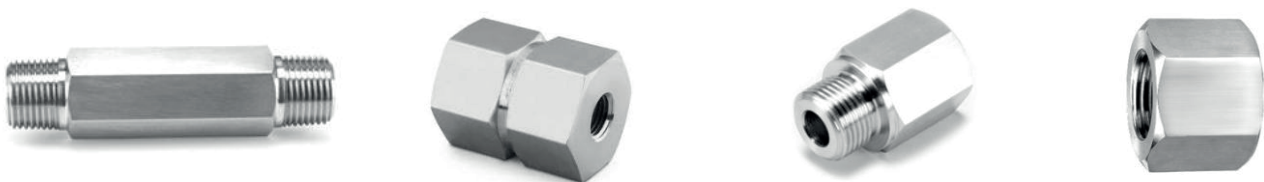

Pipe Fittings

Instrumentation Pipe Fittings

DS-LOK Instrumentation Pipe Fittings are offered in popular configurations such as reducing adapters, reducing bishings, pipe unions, elbows, tees, crosses, etc.

Fittings are manufactured to the same high quality standards as other DS-LOK. Each fitting is thoroughly cleaned to eliminate system contamination and features an attractive surface finish to enhance the appearance of modern scientific instrumentation and equipment. Fittings are manufactured from materials meeting applicable ASTM or ASME specifications, with pipe threads which meet or exceed ANSI/ASME B1.20.1 requirements. Strict quality control procedures are followed throughout production. Pipe thread connections are very common in today's industry. They are relatively easy to work with because of the common sizes and dimensions throughout manufacturing. It is important to use a thread sealant. These products range from pipe "dopes" to Teflon tape, all of which can be purchased through your local DS-LOK Distributor.

Threads

Threads utilized on DS-LOK Precision Instrument Pipe fittings are National Pipe Taper (NPT) which exceed the requirements of ANSI B1.20.1

DS-LOK Precision Pipe Fittings are available as standard in Brass and 316 Stainless Steel. DS-LOK pipe fittings can also be supplied in other materials including, Monel, Hastelloy C, Inconel and Titanium and in special shapes. Specifications for standard materials are:

Material	Bar Stock	Forgings
316 stainless steel	ASME SA479, ASTM A276	ASME SA182, ASTM A182
Brass	ASME B16, ASTM B453	ASTM B283
Carbon steel	ASTM A108	—

- DS-LOK Pipe Fittings are fully interchangeable with Swagelok and Parker A-Lok
- Sizes: Fractional 1/16" - 2"
- Materials: Stainless Steel (316L, 316, 304, 304L) Brass, Carbon Steel, Monel, Inconel
- Pressure Ratings: 6000 PSI, 15 000 PSI

Pressure Ratings Basic

Pressure ratings are based on ASME Code, Specification for standard pressure rating are:

Material	Allowable Stress Value
316 stainless steel	20 000 psig (1378 bar)
Brass	10 000 psig (689 bar)
Carbon steel	20 000 psig (1378 bar)

Design/Features

DS-LOK Instrumentation Pipe Fitting are manufactured to the same high quality standards as other DS-LOK Fitting. Each fitting is thoroughly cleaned to eliminate system contamination and features an attractive surface finish to enhance the appearance modern scientific instrumentation and equipment.

NPT Thread are based on Requirements of ASME B1.20.1 SAE AS71051

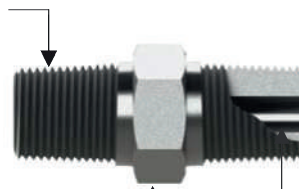

Straight Fittings are manufacturing From quality bar stock for strength

Burr-free Internal Surface

Quality Management System

The quality system complies with the international standard ISO 9001:2015 and its technical equivalent, ANSI/ISO/ASQ Q9001:2015. DS-LOK strives to continuously improve the effectiveness of the Quality Management System.

FEMALE TO MALE ADAPTER

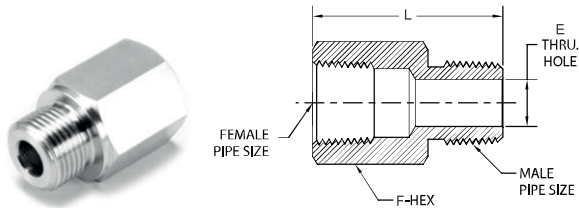

PART NO.	FEMALE PIPE SIZE	MALE PIPE SIZE	Dimensions in inches		
			L	E	F
D-AMF-2N	1/8	1/8	1.062	0.187	9/16
D-AMF-4N	1/4	1/4	1.375	0.281	3/4
D-AMF-6N	3/8	3/8	1.562	0.375	7/8
D-AMF-8N	1/2	1/2	1.906	0.468	1-1/16
D-AMF-12N	3/4	3/4	1.937	0.625	1-5/16
D-AMF-16N	1	1	2.281	0.875	1-5/8

PART NO.	FEMALE PIPE SIZE	Dimensions in inches	
		L	E
D-EC-2N	1/8	0.750	9/16
D-EC-4N	1/4	0.906	3/4
D-EC-6N	3/8	1.031	7/8
D-EC-8N	1/2	1.343	1-1/16
D-EC-12N	3/4	1.437	1-5/16
D-EC-16N	1	1.625	1-5/8

FEMALE CAP

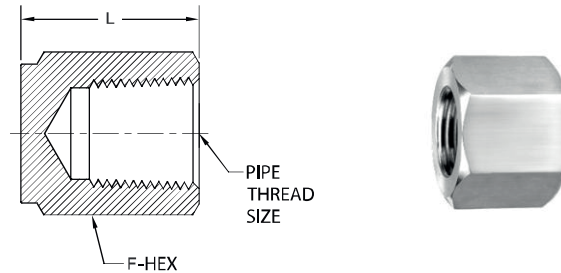

FEMALE REDUCER UNION

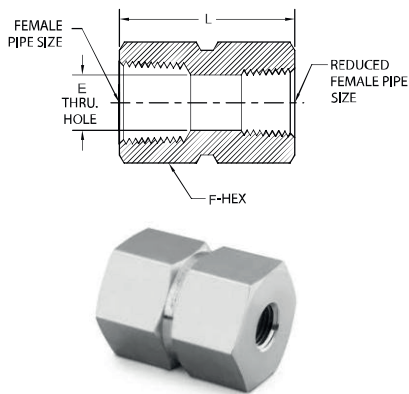

PART NO.	FEMALE PIPE SIZE	REDUCED FEMALE PIPE SIZE	Dimensions in inches		
			L	E	F
D-FRU-4N-2N	1/4	1/8	1.218	0.328	3/4
D-FRU-6N-4N	3/8	1/4	1.375	0.421	7/8
D-FRU-8N-2N	1/2	1/8	1.562	0.328	1-1/16
D-FRU-8N-4N	1/2	1/4	1.750	0.421	1-1/16
D-FRU-8N-6N	1/2	3/8	1.781	0.562	1-1/16
D-FRU-12N-4N	3/4	1/4	1.812	0.421	1-5/16
D-FRU-12N-8N	3/4	1/2	2.062	0.687	1-5/16
D-FRU-16N-8N	1	1/2	2.187	0.687	1-5/8
D-FRU-16N-12N	1	3/4	2.250	0.890	1-5/8

PART NO.	FEMALE PIPE SIZE	Dimensions in inches		
		L	E	F
D-FU-2N	1/8	0.812	0.328	9/16
D-FU-4N	1/4	1.187	0.421	3/4
D-FU-6N	3/8	1.312	0.562	7/8
D-FU-8N	1/2	1.625	0.687	1-1/16
D-FU-12N	3/4	1.687	0.890	1-5/16
D-FU-16N	1	2.000	1.125	1-5/8

FEMALE UNION

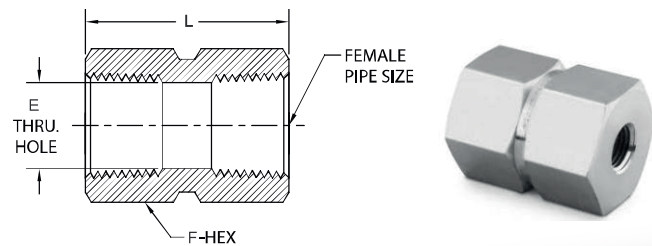

HEX LONG NIPPLE

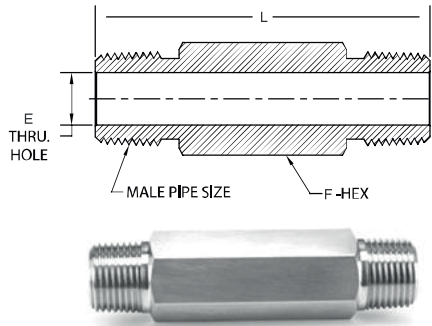

PART NO.	MALE PIPE SIZE	Dimensions in inches		
		L	E	F
D-HNL-2N	1/8	Made To Order Specify Size	0.187	7/16
D-HNL-4N	1/4		0.281	9/16
D-HNL-6N	3/8		0.375	1/16
D-HNL-8N	1/2		0.468	7/8
D-HNL-12N	3/4		0.625	1-1/16
D-HNL-16N	1		0.875	1-3/8

HEX NIPPLE

PART NO.	MALE PIPE SIZE	Dimensions in inches		
		L	E	F
D-HN-1N	1/16	0.931	0.125	3/8
D-HN-2N	1/8	1.000	0.187	7/16
D-HN-4N	1/4	1.375	0.281	9/16
D-HN-6N	3/8	1.406	0.375	11/16
D-HN-8N	1/2	1.781	0.468	7/8
D-HN-12N	3/4	1.812	0.625	1-1/16
D-HN-16N	1	2.281	0.875	1-3/8

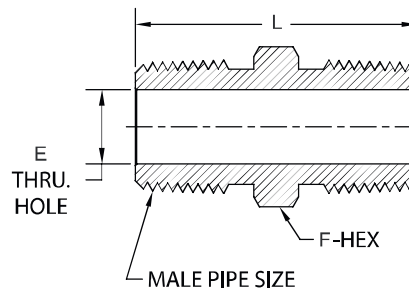

HEX REDUCING NIPPLE

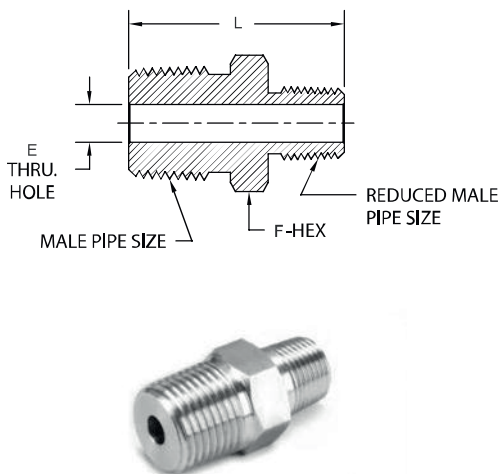

PART NO.	MALE PIPE SIZE	REDUCED MALE PIPE SIZE	Dimensions in inches		
			L	E	F
D-HRN-2N-1N	1/8	1/16	1.000	0.125	7/16
D-HRN-4N-2N	1/4	1/8	1.187	0.187	9/16
D-HRN-6N-2N	3/8	1/8	1.218	0.187	1/16
D-HRN-6N-4N	3/8	1/4	1.406	0.281	11/16
D-HRN-8N-2N	1/2	1/8	1.406	0.187	7/8
D-HRN-8N-4N	1/2	1/4	1.593	0.281	7/8
D-HRN-8N-6N	1/2	3/8	1.625	0.375	7/8
D-HRN-12N-4N	3/4	1/4	1.625	0.281	1-1/16
D-HRN-12N-8N	3/4	1/2	1.812	0.468	1-1/16
D-HRN-16N-4N	1	1/4	1.906	0.281	1-3/8
D-HRN-16N-8N	1	1/2	2.093	0.468	1-3/8
D-HRN-16N-12N	1	3/4	2.093	0.625	1-3/8

BLIND PLUG

PART NO.	MALE PIPE SIZE	Dimensions in inches	
		L	F
D-PG-2N	1/8	0.750	7/16
D-PG-4N	1/4	1.000	9/16
D-PG-6N	3/8	1.000	11/16
D-PG-8N	1/2	1.312	7/8
D-PG-12N	3/4	1.375	1-1/16
D-PG-16N	1	1.500	1-3/8

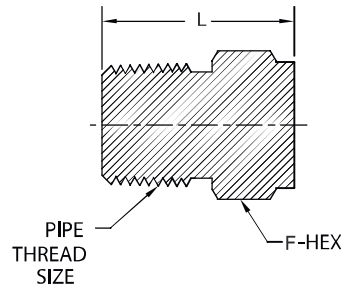

REDUCER ADAPTER - FEMALE TO MALE

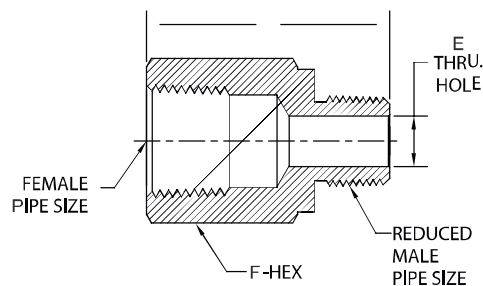

PART NO.	FEMALE PIPE SIZE	REDUCED MALE PIPE SIZE	Dimensions in inches		
			L	E	F
D-RAMF-2N-1N	1/8	1/16	1.093	0.125	9/16
D-RAMF-4N-2N	1/4	1/8	1.250	0.187	3/4
D-RAMF-6N-2N	3/8	1/8	1.437	0.187	7/8
D-RAMF-6N-4N	3/8	1/4	1.562	0.281	7/8
D-RAMF-8N-2N	1/2	1/8	1.687	0.187	1-1/16
D-RAMF-8N-4N	1/2	1/4	1.812	0.281	1-1/16
D-RAMF-8N-6N	1/2	3/8	1.812	0.375	1-1/16
D-RAMF-12N-4N	3/4	1/4	1.968	0.281	1-5/16
D-RAMF-12N-6N	3/4	3/8	1.968	0.375	1-5/16
D-RAMF-12N-8N	3/4	1/2	2.062	0.468	1-5/16
D-RAMF-16N-4N	1	1/4	2.125	0.281	1-5/8
D-RAMF-16N-8N	1	1/2	2.250	0.468	1-5/8
D-RAMF-16N-12N	1	3/4	2.250	0.625	1-5/8

REDUCER BUSHING

PART NO.	MALE PIPE SIZE	REDUCED MALE PIPE SIZE	Dimensions in inches		
			L	E	F
D-RB-2N-1N	1/8	1/16	1.000	0.187	7/16
D-RB-4N-2N	1/4	1/8	1.000	0.281	9/16
D-RB-6N-2N	3/8	1/8	0.843	0.328	11/16
D-RB-6N-4N	3/8	1/4	1.125	0.375	3/4
D-RB-8N-2N	1/2	1/8	1.062	0.328	7/8
D-RB-8N-4N	1/2	1/4	1.062	0.421	7/8
D-RB-8N-6N	1/2	3/8	1.312	0.468	7/8
D-RB-12N-4N	3/4	1/4	1.062	0.421	1-1/16
D-RB-12N-6N	3/4	3/8	1.062	0.562	1-1/16
D-RB-12N-8N	3/4	1/2	1.562	0.625	1-1/16
D-RB-16N-4N	1	1/4	1.343	0.421	1-3/8
D-RB-16N-6N	1	3/8	1.343	0.562	1-3/8
D-RB-16N-8N	1	1/2	1.343	0.687	1-3/8
D-RB-16N-12N	1	3/4	1.750	0.875	1-3/8

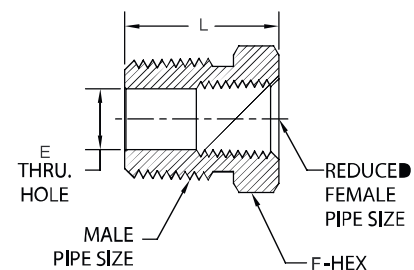

FEMALE ELBOW

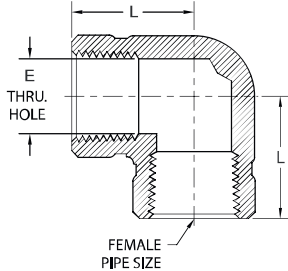

PART NO.	FEMALE PIPE SIZE	Dimensions in inches	
		L	E
D-FE-2N	1/8	0.843	0.328
D-FE-4N	1/4	0.968	0.421
D-FE-6N	3/8	1.000	0.562
D-FE-8N	1/2	1.125	0.687
D-FE-12N	3/4	1.437	0.890

FEMALE - MALE ELBOW

PART NO.	MALE PIPE SIZE	Dimensions in inches		
		L	E	F
D-MFE-2N	1/8	0.843	0.843	0.187
D-MFE-4N	1/4	0.843	1.093	0.281
D-MFE-6N	3/8	1.000	1.125	0.375
D-MFE-8N	1/2	1.125	1.375	0.468
D-MFE-12N	3/4	1.437	1.562	0.625
D-MFE-16N	1	1.906	1.906	0.875

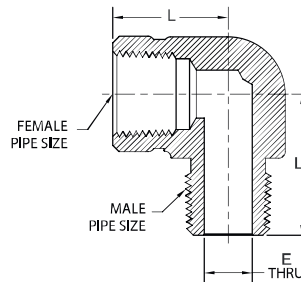

FEMALE - MALE REDUCER ELBOW

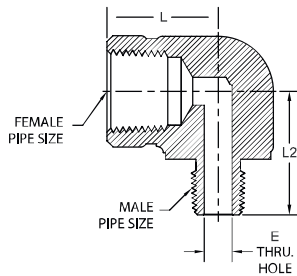

PART NO.	FEMALE PIPE SIZE	MALE PIPE SIZE	Dimensions in inch		
			L	L2	E
D-FMRE-2N-1N	1/8	1/16	0.750	0.750	0.125
D-FMRE-2N-1N	1/4	1/8	0.843	0.937	0.187
D-FMRE-2N-1N	3/8	1/4	1.062	1.062	0.281
D-FMRE-2N-1N	1/2	1/4	1.125	1.250	0.281
D-FMRE-2N-1N	1/2	3/8	1.125	1.250	0.375

MALE ELBOW

PART NO.	MALE PIPE SIZE	Dimensions in inches	
		L	E
D-ME-2N	1/8	0.750	0.187
D-ME-4N	1/4	1.000	0.281
D-ME-6N	3/8	1.093	0.375
D-ME-8N	1/2	1.375	0.468
D-ME-12N	3/4	1.500	0.625
D-ME-16N	1	1.875	0.875

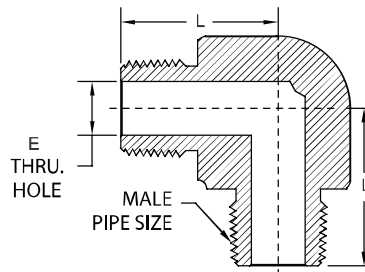

STREET TEE

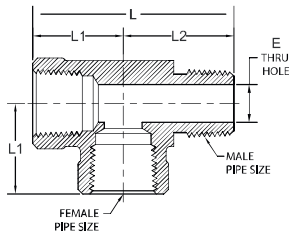

PART NO.	PIPE SIZES	Dimensions in inch			
		L	L1	L2	E
D-MRT-2N	1/8	1.687	0.843	0.843	0.187
D-MRT-4N	1/4	1.890	0.843	1.046	0.281
D-MRT-6N	3/8	2.125	1.000	1.125	0.375
D-MRT-8N	1/2	2.500	1.125	1.375	0.468
D-MRT-12N	3/4	2.937	1.437	1.500	0.625

PART NO.	FEMALE PIPE SIZE	Dimensions in inch		
		L	L2	E
D-FT-2N	1/8	1.687	0.843	0.328
D-FT-4N	1/4	1.687	0.843	0.421
D-FT-6N	3/8	2.000	1.000	0.562
D-FT-8N	1/2	2.250	1.125	0.687
D-FT-12N	3/4	2.625	1.312	0.890
D-FT-16N	1	3.250	1.6251	0.125

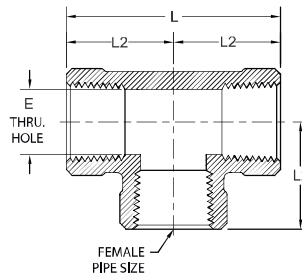

FEMALE TEE



BRANCH TEE

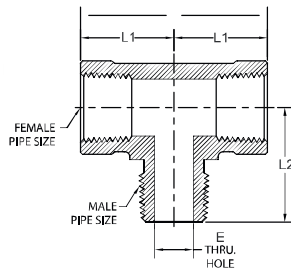

PART NO.	PIPE SIZES	Dimensions in inch			
		L	L1	L2	E
D-MBT-2N	1/8	1.687	0.843	0.843	0.187
D-MBT-4N	1/4	1.875	0.937	1.000	0.281
D-MBT-6N	3/8	2.000	1.000	1.125	0.375
D-MBT-8N	1/2	2.250	1.125	1.375	0.468
D-MBT-12N	3/4	2.750	1.375	1.625	0.625

PART NO.	MALE PIPE SIZE	Dimensions in inch		
		L	L1	E
D-MT-2N	1/8	1.437	0.718	0.187
D-MT-4N	1/4	1.875	0.937	0.281
D-MT-6N	3/8	2.000	1.000	0.375
D-MT-8N	1/2	2.750	1.375	0.468
D-MT-12N	3/4	2.750	1.375	0.625

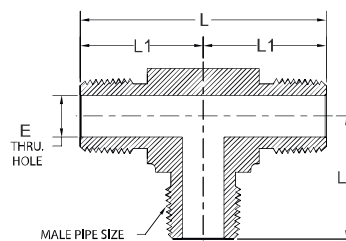

MALE TEE



BRANCH TEE

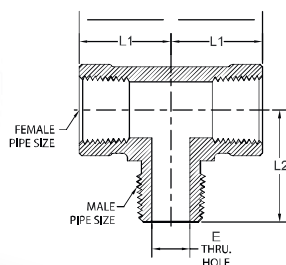

PART NO.	PIPE SIZES	Dimensions in inch			
		L	L1	L2	E
D-MBT-2N	1/8	1.687	0.843	0.843	0.187
D-MBT-4N	1/4	1.875	0.937	1.000	0.281
D-MBT-6N	3/8	2.000	1.000	1.125	0.375
D-MBT-8N	1/2	2.250	1.125	1.375	0.468
D-MBT-12N	3/4	2.750	1.375	1.625	0.625

HEX LONG NIPPLE

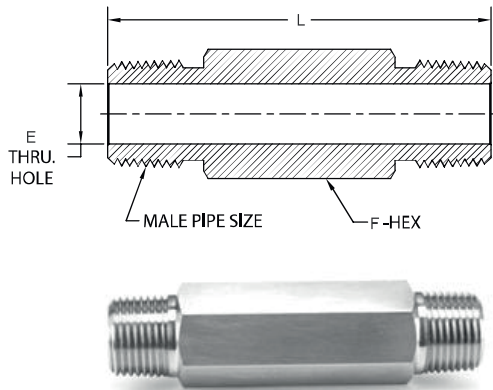

PART NO.	Connection Type	Dimensions in inch		
		L	E	F
D-PF15M4P-4	1/4" NPT	4.00	0.201	0.69
D-PF15M4P-6		6.00		
D-PF15M4P-8		8.00		
D-PF15M6P-4	3/8" NPT	4.00	0.312	0.88
D-PF15M6P-6		6.00		
D-PF15M6P-8		8.00		
D-PF15M8P-4	1/2" NPT	4.00	0.312	1.06
D-PF15M8P-6		6.00		
D-PF15M8P-8		8.00		
D-PF15M12P-4	3/4" NPT	4.00	0.685	1.44
D-PF15M12P-6		6.00		
D-PF15M12P-8		8.00		
D-PF15M16P-4	1" NPT	4.00	0.685	1.44
D-PF15M16P-6		6.00		
D-PF15M16P-8		8.00		

PART NO.	Connection Type	Dimensions in inch		
		L	E	F
D-PF15M4P	1/4"NPT	1.85	0.201	0.69
D-PF15M6P	3/8"NPT	1.89	0.312	0.88
D-PF15M8P	1/2"NPT	2.50	0.312	1.06
D-PF15M12P	3/4"NPT	2.81	0.685	1.44
D-PF15M16P	1"NPT	3.19	0.685	1.44

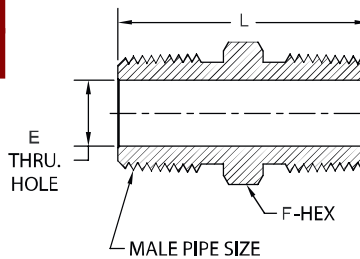

HEX CLOSE NIPPLE



STREET TEE

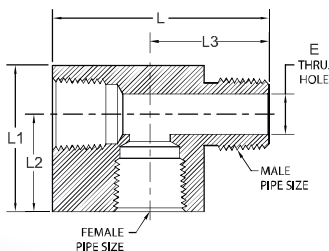

PART NO.	Connection Type	Dimensions in inch					Block Thickness
		L	L1	L2	L3	E	
D-PF15SPT4P	1/4" NPT	2.00	1.38	1.00	1.15	0.201	0.79
D-PF15SPT6P	3/8" NPT	2.50	1.50	1.00	1.50	0.312	1.02
D-PF15SPT8P	1/2" NPT	3.00	2.00	1.25	1.63	0.312	1.26
D-PF15SPT12P	3/4" NPT	3.15	2.62	1.70	1.85	0.685	1.54
D-PF15SPT16P	1" NPT	4.13	2.99	2.13	2.13	0.685	1.77

MALE TEE

PART NO.	Connection Type	Dimensions in inch					Block Thickness
		L	L1	L2	L3	E	
D-PF15MPT4P	1/4" NPT	2.26	1.50	1.13	1.13	0.201	0.79
D-PF15MPT6P	3/8" NPT	2.50	1.75	1.25	1.25	0.312	1.02
D-PF15MPT8P	1/2" NPT	3.00	2.00	1.50	1.50	0.312	1.02
D-PF15MPT12P	3/4" NPT	3.50	2.62	1.77	1.75	0.685	1.54
D-PF15MPT16P	1" NPT	4.13	2.99	2.13	2.07	0.685	1.77

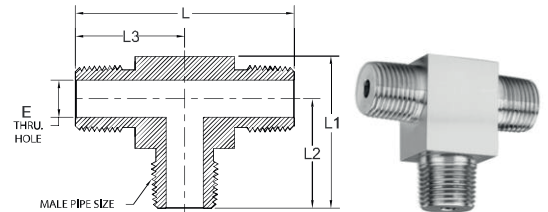

MALE BRANCH TEE

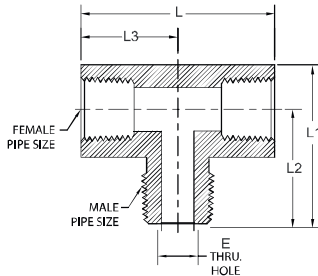

PART NO.	Connection Type	Dimensions in inch					Block Thickness
		L	L1	L2	L3	E	
D-PF15BPT4P	1/4" NPT	2.00	1.50	1.13	1.00	0.201	0.79
D-PF15BPT6P	3/8" NPT	2.00	1.75	1.25	1.00	0.312	1.02
D-PF15BPT8P	1/2" NPT	3.00	2.25	1.62	1.50	0.312	1.02
D-PF15BPT12P	3/4" NPT	3.00	2.62	1.87	1.50	0.685	1.54
D-PF15BPT16P	1" NPT	4.13	2.99	2.13	2.07	0.685	1.77

STREET ELBOW

PART NO.	Connection Type	Dimensions in inch					Block Thickness
		L	L1	L2	L3	E	
D-PF15SPL4P	1/4" NPT	1.50	1.50	1.13	1.00	0.201	0.79
D-PF15SPL6P	3/8" NPT	1.76	1.50	1.25	1.00	0.312	1.02
D-PF15SPL8P	1/2" NPT	2.25	2.00	1.63	1.25	0.312	1.02
D-PF15SPL12P	3/4" NPT	2.50	2.62	1.81	1.70	0.685	1.54
D-PF15SPL16P	1" NPT	2.99	2.99	2.13	2.01	0.685	1.77

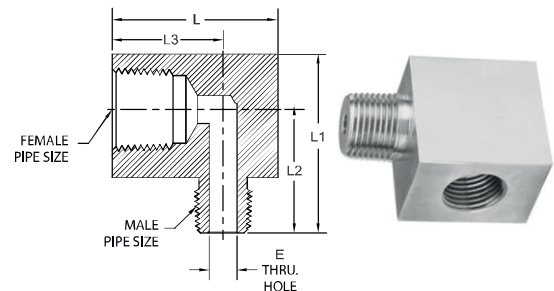

MALE ELBOW

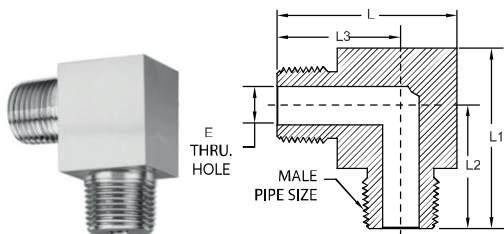

PART NO.	Connection Type	Dimensions in inch					Block Thickness
		L	L1	L2	L3	E	
D-PF15MPL4P	1/4" NPT	1.50	1.50	1.13	1.13	0.201	0.79
D-PF15MPL6P	3/8" NPT	1.75	1.75	1.25	1.25	0.312	1.02
D-PF15MPL8P	1/2" NPT	2.00	2.00	1.47	1.47	0.312	1.02
D-PF15MPL12P	3/4" NPT	2.62	2.62	1.87	1.87	0.685	1.54
D-PF15MPL16P	1" NPT	2.99	2.99	2.13	2.13	0.685	1.77

STREET ELBOW

PART NO.	Connection Type	Dimensions in inch					Block Thickness
		L	L1	L2	L3	E	
D-PF15SPL4P	1/4"NPT	1.50	1.50	1.13	1.00	0.201	0.79
D-PF15SPL6P	3/8"NPT	1.76	1.50	1.25	1.00	0.312	1.02
D-PF15SPL8P	1/2"NPT	2.25	2.00	1.63	1.25	0.312	1.02
D-PF15SPL12P	3/4"NPT	2.50	2.62	1.81	1.70	0.685	1.54
D-PF15SPL16P	1"NPT	2.99	2.99	2.13	2.01	0.685	1.77

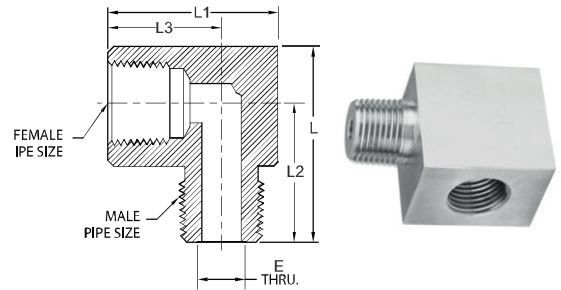

COUPLING (FEMALE UNION)

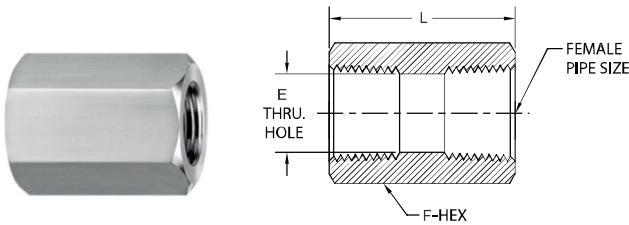

PART NO.	Connection Type	Dimensions in inch		
		L	E	F
D-PF15F4P	1/4"NPT	1.50	0.201	0.81
D-PF15F6P	3/8"NPT	1.63	0.312	1.06
D-PF15F8P	1/2"NPT	2.05	0.312	1.19
D-PF15F12P	3/4"NPT	2.72	0.685	1.44
D-PF15F16P	1"NPT	2.52	0.685	2.00

ELBOW

PART NO.	Connection Type	Dimensions in inch								Block Thickness
		L	L1	L2	L3	L4	L5	D	E	
D-PF-15L4P	1/4"NPT	1.54	1.14	0.75	0.75	0.49	0.49	0.22	0.201	0.79
D-PF-15L6P	3/8"NPT	2.01	1.50	1.00	1.00	0.63	0.63	0.26	0.312	1.02
D-PF-15L8P	1/2"NPT	2.99	1.89	1.50	1.25	1.08	0.84	0.33	0.312	1.38
D-PF-15L12P	3/4"NPT	2.99	2.24	1.50	1.50	1.00	1.00	0.35	0.685	1.38
D-PF-15L16P	1"NPT	4.13	2.52	2.07	1.57	1.38	1.10	0.53	0.685	1.77

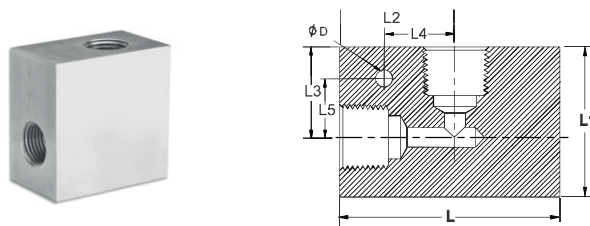

PLUG

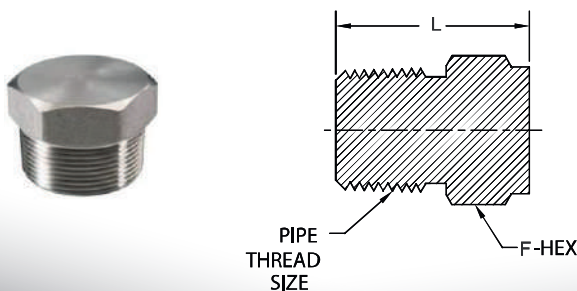

PART NO.	Connection Type	Dimensions in inch	
		L	F
D-PF-15P4P	1/4"NPT	1.10	0.69
D-PF-15P6P	3/8"NPT	1.10	0.88
D-PF-15P8P	1/2"NPT	1.50	1.06
D-PF-15P12P	3/4"NPT	1.50	1.44
D-PF-15P16P	1"NPT	1.89	1.44

TEE

PART NO.	Connection Type	Dimensions in inch								Block Thickness
		L	L1	L2	L3	L4	L5	D	E	
DPF-15T4P	1/4"NPT	1.54	1.14	0.77	0.75	1.02	0.49	0.22	0.201	0.79
DPF-15T6P	3/8"NPT	2.01	1.50	1.00	1.00	1.26	0.63	0.26	0.312	1.02
DPF-15T8P	1/2"NPT	2.99	1.89	1.50	1.25	2.00	0.84	0.33	0.312	1.38
DPF-15T12P	3/4"NPT	2.99	2.20	1.50	1.50	2.00	1.00	0.35	0.685	1.38
DPF-15T16P	1"NPT	4.13	2.52	2.07	1.57	2.76	1.10	0.53	0.685	1.77

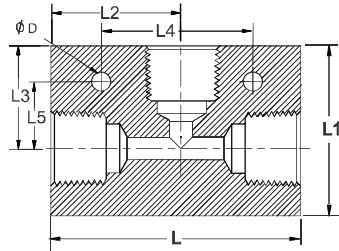

CROSS

PART NO.	Connection Type	Dimensions in inch								Block Thickness
		L	L1	L2	L3	L4	L5	D	E	
DPF-15X4P	1/4"NPT	1.54	1.54	0.77	0.77	0.98	0.49	0.22	0.201	0.79
DPF-15X6P	3/8"NPT	2.01	2.01	1.00	1.00	1.26	0.63	0.26	0.312	1.02
DPF-15X8P	1/2"NPT	2.99	2.52	1.50	1.26	2.01	0.84	0.35	0.312	1.38
DPF-15X12P	3/4"NPT	2.99	2.99	1.50	1.50	2.01	1.00	0.35	0.685	1.38
DPF-15X16P	1"NPT	4.13	3.15	2.07	1.57	2.76	1.10	0.53	0.685	1.77

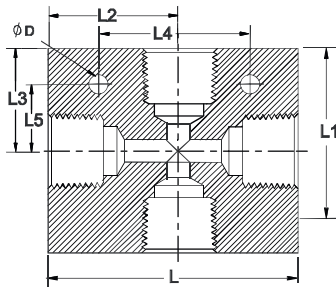



DS-LOK

INSTRUMENTATION VALVES AND FITTINGS



Valves

- Needle Valves
- Manifold Valves
- In Line Check Valve
- Proportional Relief Valves
- Instrument Ball Valves
- Mono Flange Valves
- Integral Block & Bleed Valves
- Bleed & Purge Valves
- Thermowells
- Pressure gauge Accessories

Fittings

- Tube Fittings
- Pipe Fittings
- High Pressure- Pipe Fittings
- Hydraulic Fittings
(DIN 2353, JIC Fittings, ORFS Fittings)

Forged Steel Valves

- Forged Steel Globe Valves (Cryogenic Available)
- Forged Steel Gate Valves (Cryogenic Available)
- Forged Steel Lift check Valves
- Forged Steel Ball Valves (Cryogenic Available)